

# 6303 Barfield Road, Building III

Atlanta, GA 30339

Central Perimeter Sublease

32,000 r.s.f. total

(16,000 r.s.f. 2<sup>nd</sup> and 3<sup>rd</sup> floors)



## Property Highlights

- Approximately 32,000 r.s.f.  
16,000 per floor
- Rate: \$16.00 full service
- Term through May 31, 2013
- Class A 5-story office building
- Parking ratio: 3.5/1000
- Improvement allowance available
- Original shell condition
- Walking distance to MARTA
- Hotel
- Multi-tenanted
- Accessible to GA 400
- Corner of Mt. Vernon Highway and Barfield Road

## For information contact:

Barbara Jeanneret  
+1 404 995 2417  
barbara.jeanneret@am.jll.com

Chris Wagner  
+1 404 995 2450  
chris.wagner@am.jll.com

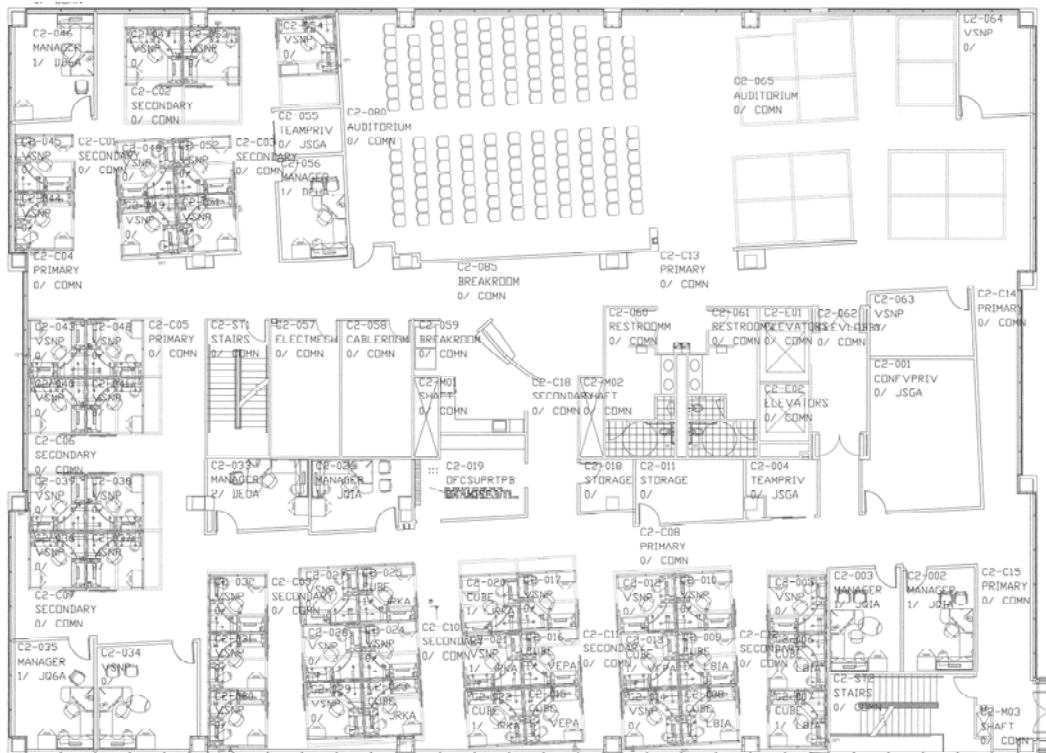
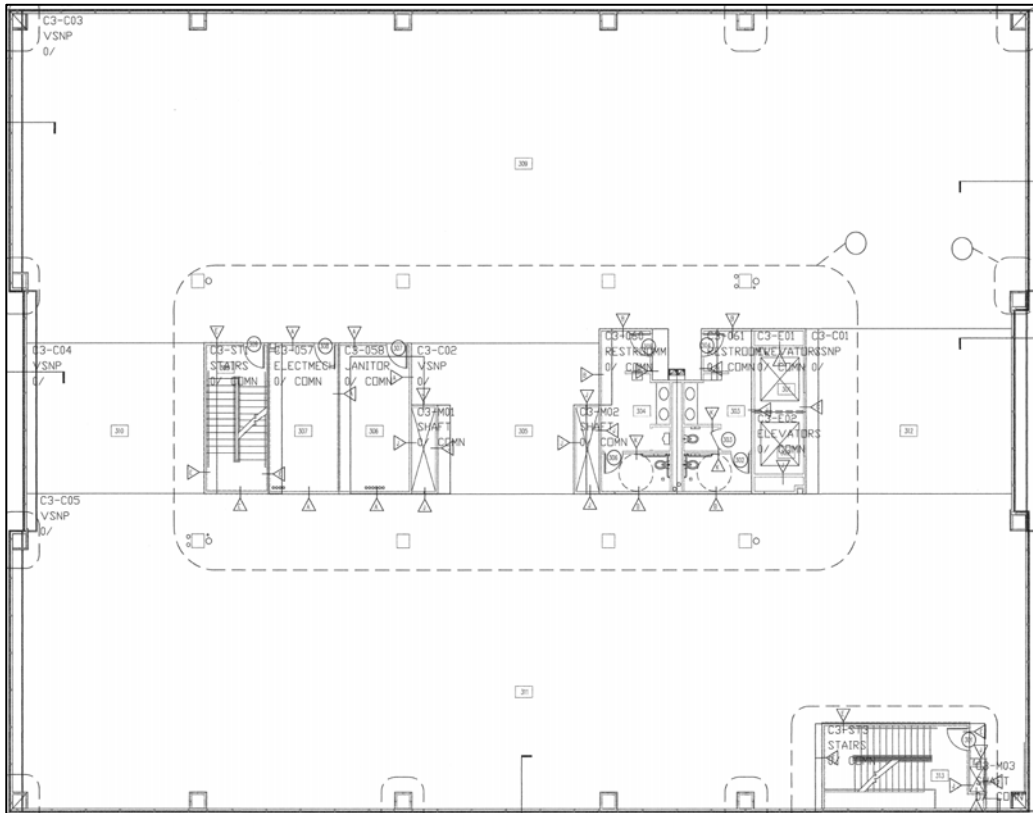

**For information contact:**

Barbara Jeanneret  
 +1 404 995 2417  
 barbara.jeanneret@am.jll.com

Chris Wagner  
 +1 404 995 2450  
 chris.wagner@am.jll.com